



24 HR NEXT DAY DESPATCH

✓ **SMOKE** VENTILATION

✓ **ENVIRO** VENTILATION

✓ **24V** POWER INPUT

✓ **O Range** COMPATIBLE

✓ **1ZONE** CONTROL

About This Product

The O Range Firefighter Switch (FS) is a manual override control for smoke ventilation systems allowing firefighters and authorised users to directly open or close smoke vents and louvres as required.

It has been designed to work in conjunction with the O Range Smoke Control Panel for smoke ventilation. It can also be used as a manual switch for daily environmental ventilation purposes i.e. activating a window actuator or vent.

Dimensions

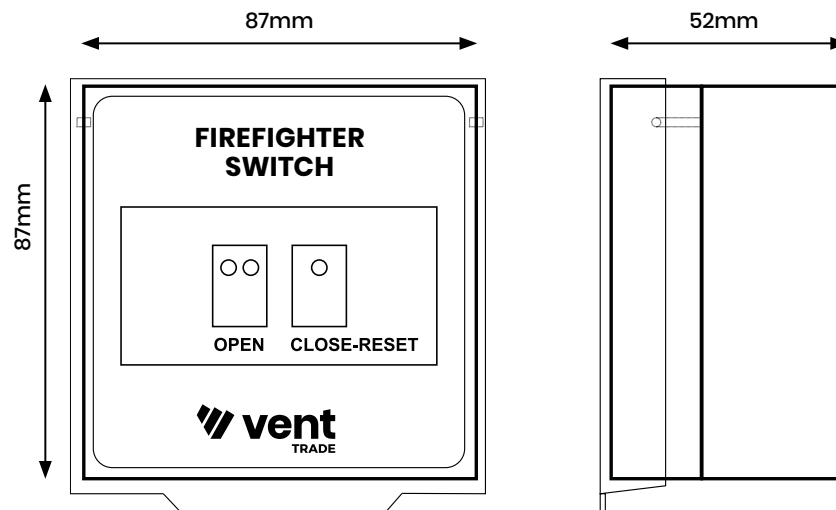

Technical Data

	O Range FS
Operating Voltage	24Vdc
No. Of Cable Cores	7 Core + Earth
Colour	Deep Orange RAL 2011

Installation Example (illustrative only)

O Range Firefighter Switches should be installed at the closest suitable position, adjacent to the firefighter point of entry.

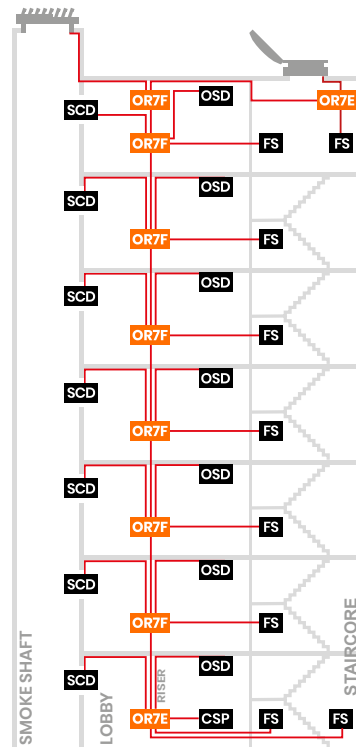

SYSTEM KEY:

OR7F	O RANGE FIELD PANEL
OR7E	O RANGE LINE END PANEL
SCD	SMOKE CONTROL DAMPER
FS	FIREFIGHTER SWITCH
OSD	OPTICAL SMOKE DETECTOR
CSP	CONTROL STATUS PANEL



Smoke ventilation systems require regular testing and record-keeping by authorised, competent persons.



...by "Accredited" and "certified smoke vent engineers only"

*REFERENCE:
DAME JUDITH HACKITT REPORT



Related Products and Services

The following should also be considered when planning your system.



O RANGE
COMPATIBLE



INSTALLATION
& MAINTENANCE



PROJECT
COMMISSIONING