



24 HR NEXT DAY
DESPATCH

✓ **SMOKE**
VENTILATION

✓ **ENVIRO**
VENTILATION

✓ **24V**
POWER INPUT

✓ **500-CB**
COMPATIBLE

About This Product

The O Range Control Status Panel (CSP) provides a visual reference to the current status of an O Range natural smoke control system. Red, amber and green LEDs indicate Fire, Fault or Healthy status – directing authorised users to test, reset or report as necessary.

Product Highlights

- Durable and stylish brushed steel fascia
- Status indication LEDs (included)
- 3 gang back box (included)

Bespoke Layout Options

- Custom text for individual zone names i.e. Floor 3 or West Wing
- 6, 9, 12, 15 or 18 LED layouts available
- Details on request

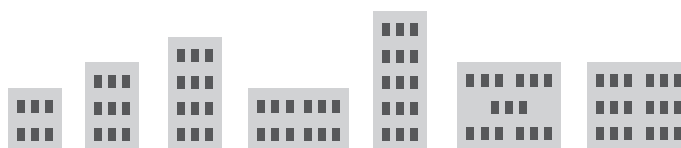

Dimensions

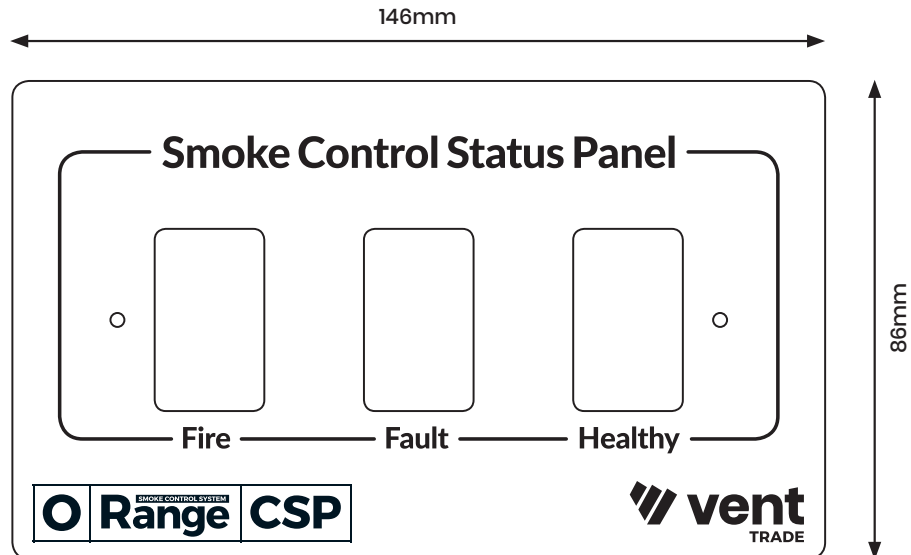

Technical Data

	O Range CSP
Operating Voltage	24Vdc
No. of Cable Cores	4 Core + Earth
Network Connection	Cat 5
Status Indication LEDs	Red, Amber and Green (included)
Back Box	Standard 3 gang (included)

Installation Example

In a multi-zone installation, an O Range CSP would typically be wired back to the lowest O Range Control Panel and typically be located in the stair core on the firefighters entrance level.

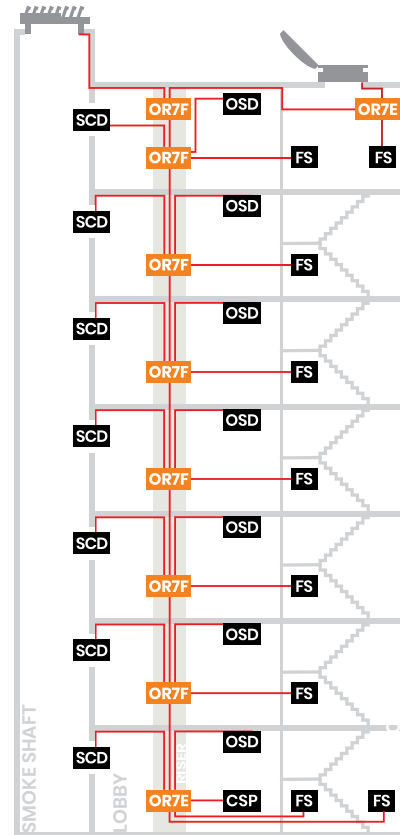

SYSTEM KEY:

OR7F	O RANGE FIELD PANEL
OR7E	O RANGE LINE END PANEL
SCD	SMOKE CONTROL DAMPER
FS	FIREFIGHTER SWITCH
OSD	OPTICAL SMOKE DETECTOR
CSP	CONTROL STATUS PANEL



Smoke ventilation systems require regular testing and record-keeping by authorised, competent persons.



...by "Accredited" and "certified smoke vent engineers only"

*REFERENCE: DAME JUDITH HACKITT REPORT



Related Products and Services

The following should also be considered when planning your system.



O RANGE COMPATIBLE



INSTALLATION & MAINTENANCE



PROJECT COMMISSIONING