



24 HR NEXT DAY
DESPATCH

✓ **SMOKE**
VENTILATION

✓ **ENVIRO**
VENTILATION

✓ **24V**
POWER INPUT

✓ **400 Series**
COMPATIBLE

✓ **O Range**
COMPATIBLE

✓ **1000-G**
COMPATIBLE

About This Product

The Ventec Blade is an automatic multi-bladed smoke exhaust louvre, designed with the primary function of dispersing smoke and heat from inside buildings to the outside. Designed for horizontal mounting (roof) or vertical mounting (facade) – see note on final page.

Product Highlights

- Overlay type base for installation on a finished upstand
- Standard sizes to suit 1.0m² or 1.5m² Geometric Free Area (GFA) regulation requirement
- Base insulation and blade material options available on request

Compliance

- BS EN 12101-2 Certified
- Approved Document L

Standard Sizes – Bespoke options available

Dimensions (Structural Opening)	GFA	Aa	Current
1400mm (W) x 1186mm (L)	1.27m ²	1.06m ²	1.0 amps
2100mm (W) x 1186mm (L)	1.92m ²	1.62m ²	1.0 amps

Dimensions (standard sizes)

- When ordering, Ventec Blade sizes are based on structural opening dimensions

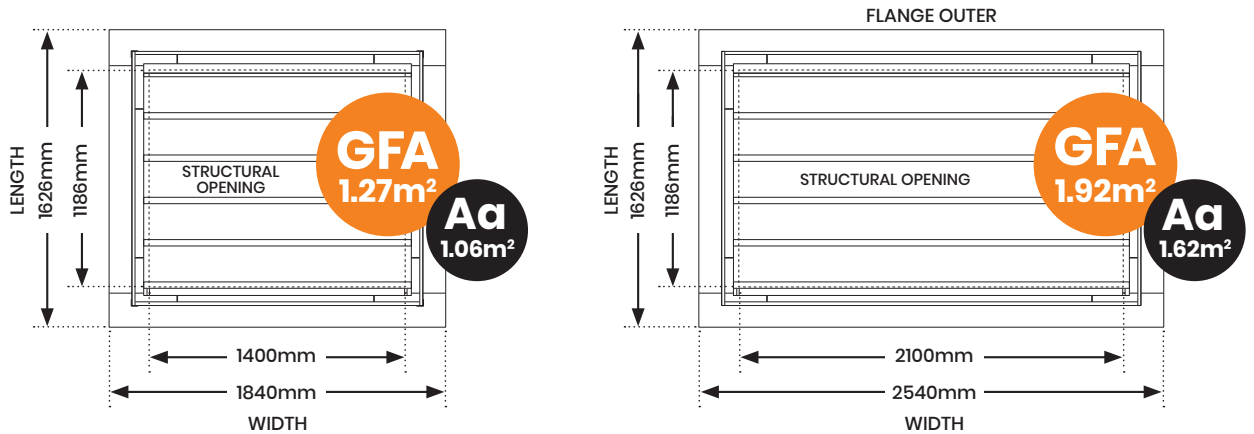

Upstand Requirements (to suit standard sizes)

- A 200mm thickness (max.) all round, 150mm tall (min.) from finished roof level, finished upstand is required to accommodate a Ventec Blade. Weathering by others.

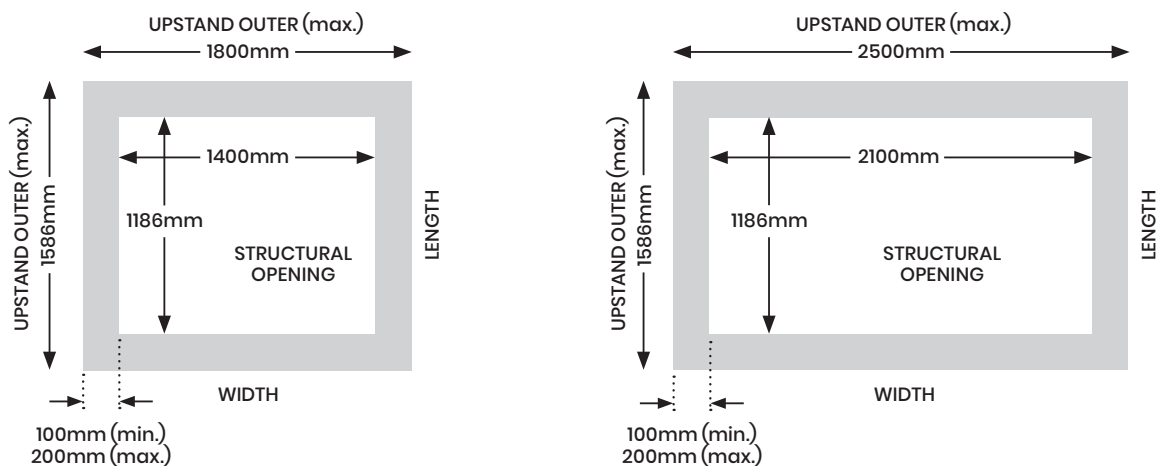

Technical Data (standard sizes)

	Ventec Blade 1.27m ² GFA	Ventec Blade 1.92m ² GFA
Structural Opening Dimensions	1400mm (W) x 1186mm (L)	2100mm (W) x 1186mm (L)
Certification	BS EN 12101-2	BS EN 12101-2
Compliance	Approved Document L	Approved Document L
Overall Unit Thermal Efficiency	U-value 2.07 (W/m ² K)	U-value 2.18 (W/m ² K)
Operating Voltage	24Vdc	24Vdc
Current Consumption	1.0 amps	1.0 amps
Geometric Free Area (GFA)	1.27m ²	1.92m ²
Aerodynamic Free Area (Aa)	1.06m ²	1.62m ²
Number Of Blades	5	5
Blade Opening Angle	90°	90°
Snow Load	SL 250	SL 250
Wind Load	WL 1500	WL 1500
Ambient Operating Temperature	-25°C to +70°C	-25°C to +70°C
Resistance Temperature High	B 300 resistance to 300°C	B300 resistance to 300°C
Vent Fire Class	E	E
Dual Purpose Reliability	Re 1000	Re 1000
Opening Time	< 60 seconds	< 60 seconds
Base Material	Aluminium	Aluminium
Base Insulation	Mineral wool	Mineral wool
Blade Material	Aluminium	Aluminium
Blade Insulation	Mineral wool	Mineral wool
Weight	70 kg	100 kg
No. Of Cable Cores	2 Core + Earth	2 Core + Earth

Vent Engineering advises that the design, supply, and installation of all electrical wiring be carried out in accordance with current standards.

Base & Flange Detail (standard sizes)

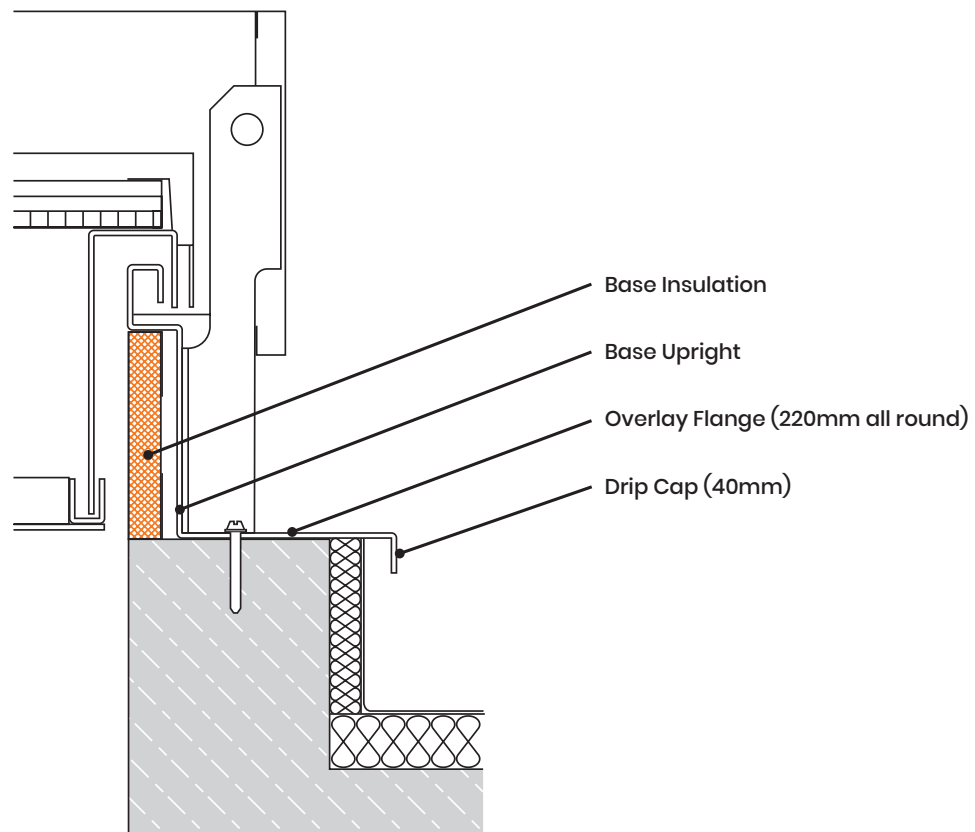

Installation: Blade Orientation

- Blade axis to remain horizontal in all installations
- Roof pitch may affect technical data stated



Product Codes

Ventec BLADE - 1.27m² GFA 1400mm(W) x 1186mm(L) RVSE-LOU-BLAD-0001
Ventec BLADE - 1.92m² GFA 2100mm(W) x 1186mm(L) RVSE-LOU-BLAD-0002

Non-standard sizes available on request

Vertical installation option, with Rain Shield – available on request



Smoke ventilation systems require regular testing and record-keeping by authorised, competent persons.



...by “Accredited” and “certified smoke vent engineers only”

*REFERENCE:
DAME JUDITH HACKITT REPORT



Related Products and Services

The following should also be considered when planning your system.



400 SERIES
BATTERY BACK-UP



VENTEC O RANGE
COMPATIBLE



VENTEC 1000-G
COMPATIBLE



INSTALLATION
& MAINTENANCE



PROJECT
COMMISSIONING